

25CM poles with two holes x 12pcs
 25CM poles with four holes x 6pcs

SPECIAL REMIND!

After mounting, do not disassemble the upright pole of the product at will or roughly! If the product needs to be disassembled, please strictly follow the below steps. Avoid product damage:

1. Press the lock of the connector with your finger

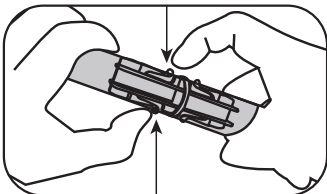

2. Important step! Please ensure that the lock is lower than the surface of the pole before pull.

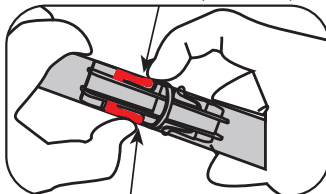

3. Please pull out the pipe horizontally.

